

PLANTA BAIXA B01
ESC. 1/20

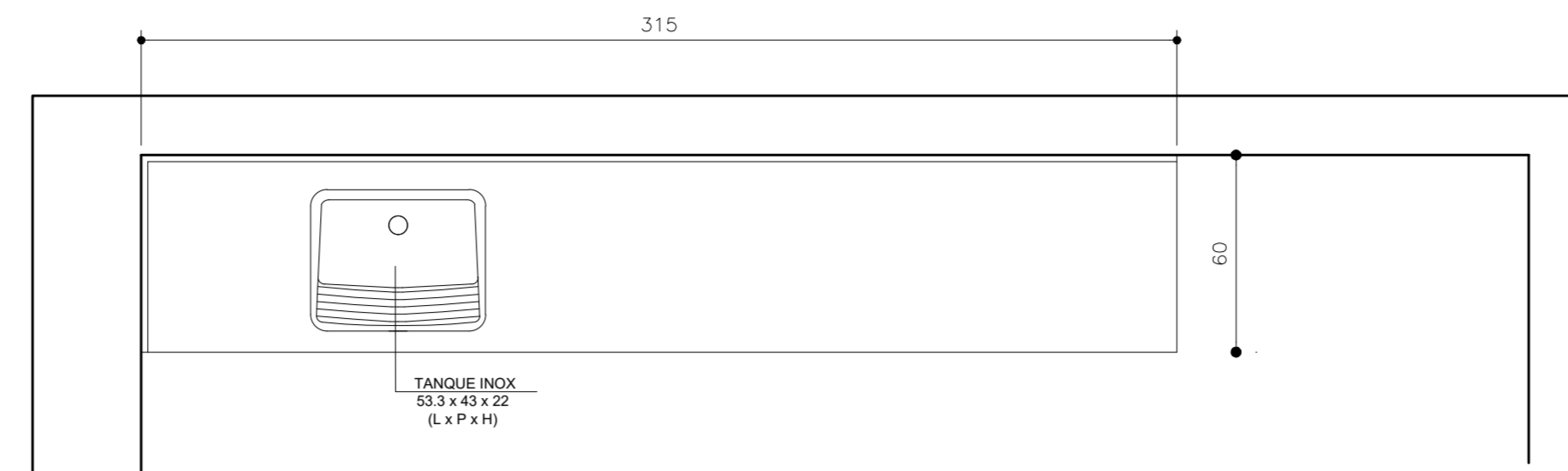

PLANTA BAIXA B02
ESC. 1/20

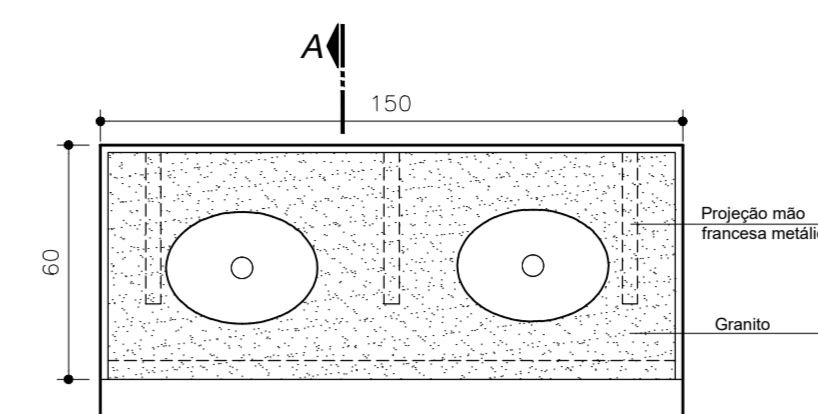

PLANTA BAIXA TAMPO B03
ESC. 1/20

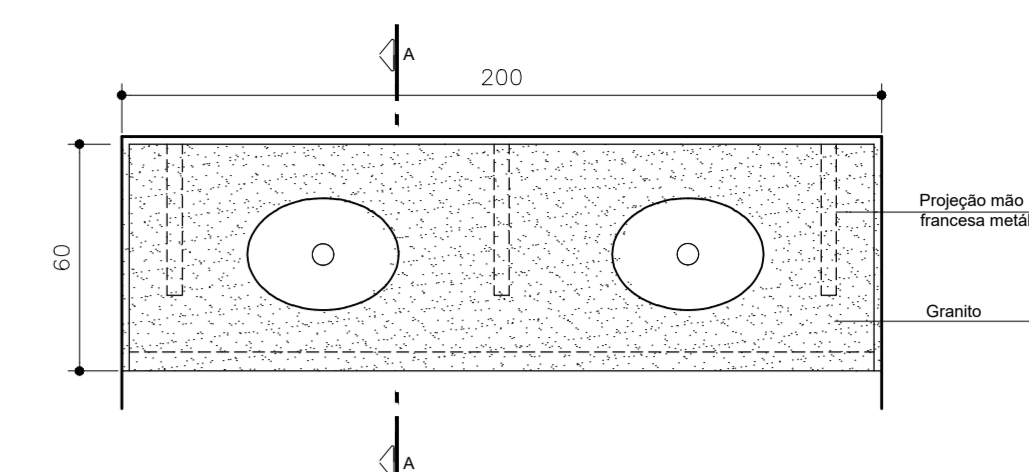

PLANTA BAIXA TAMPO B04
ESC. 1/20

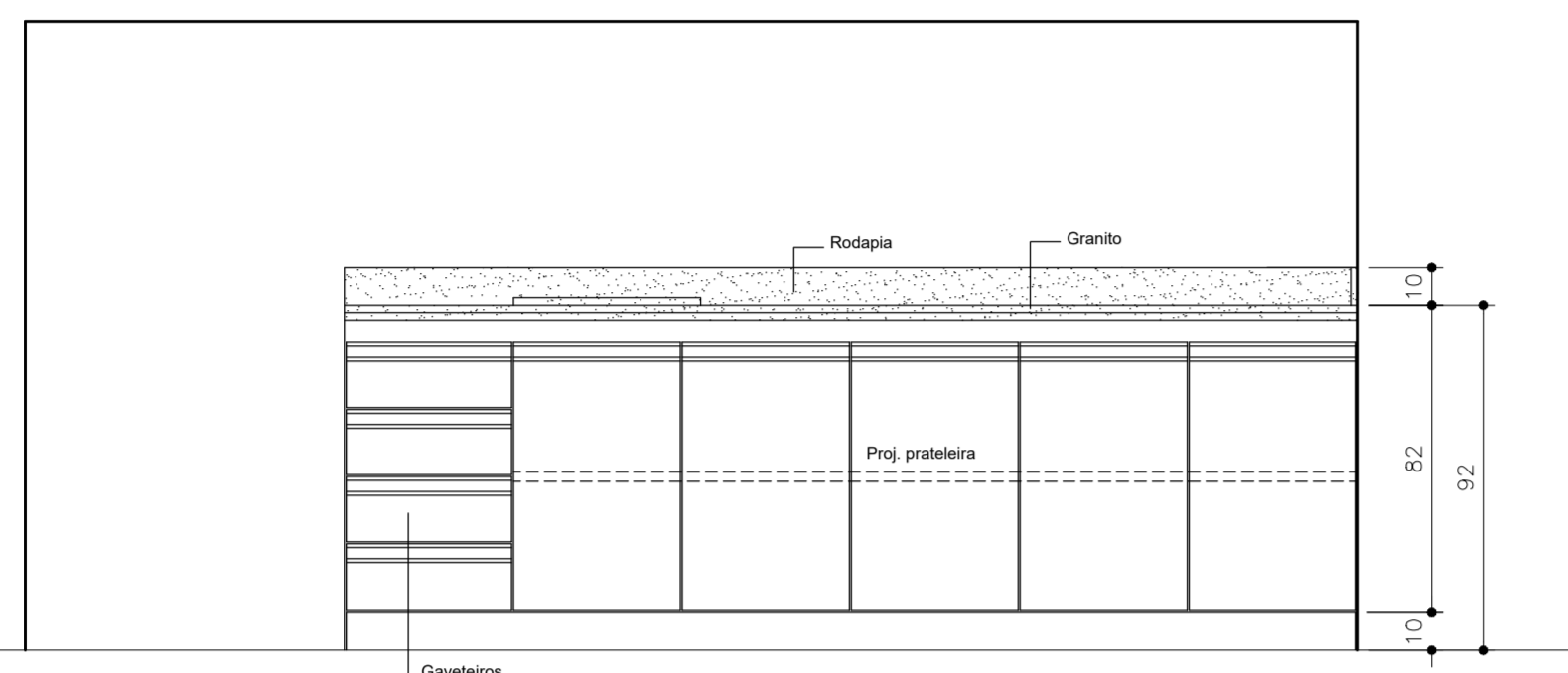

VISTA FRONTAL B01
ESC. 1/20

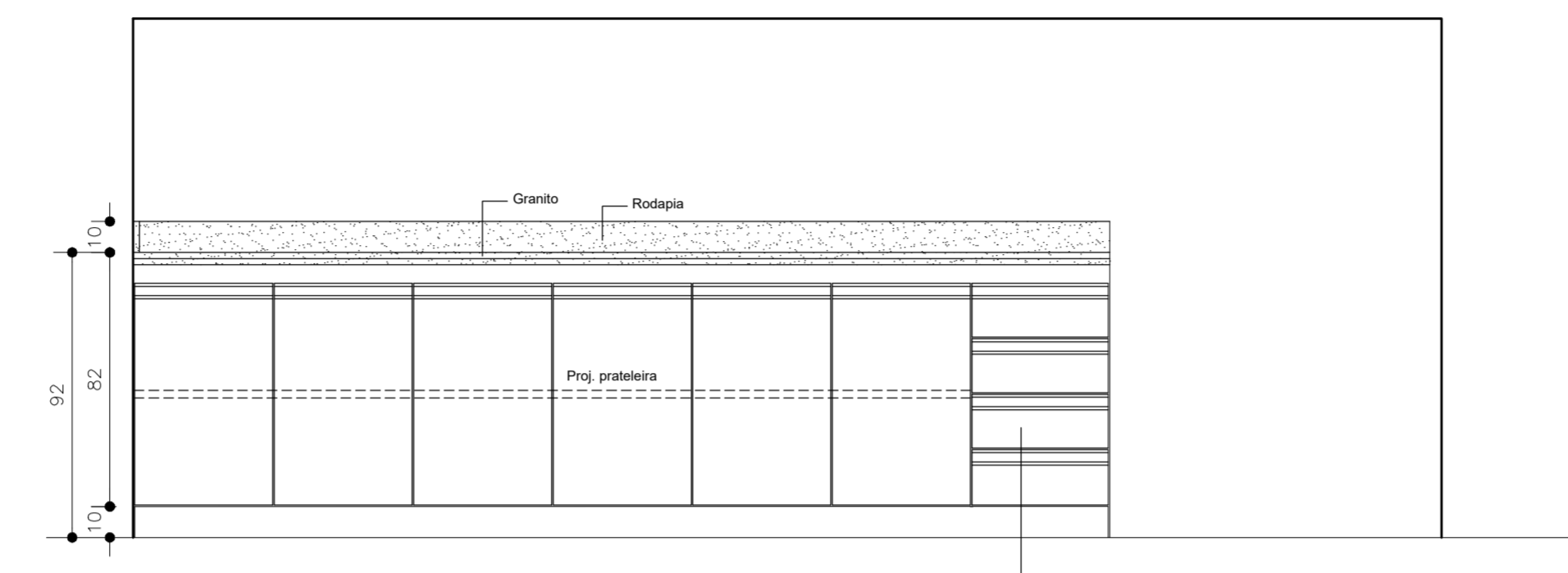

VISTA FRONTAL B02
ESC. 1/20

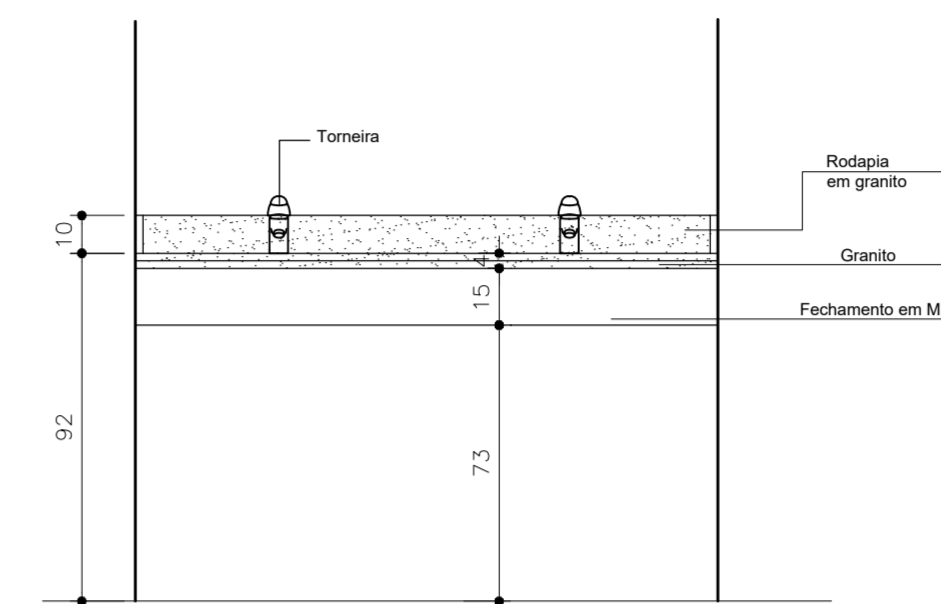

VISTA FRONTAL B03
ESC. 1/20

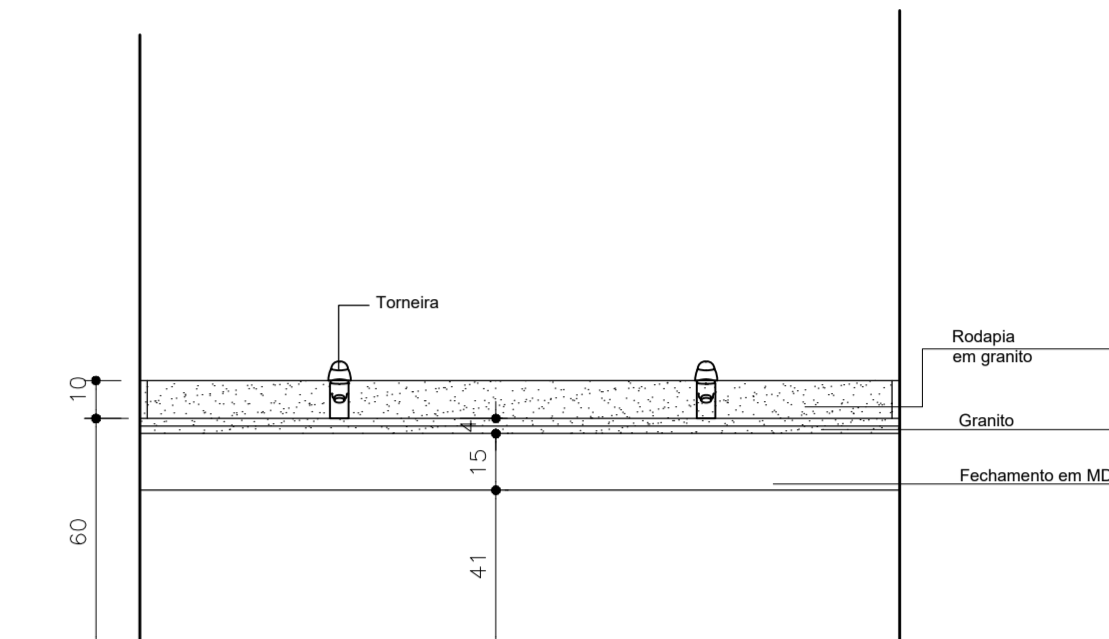

VISTA FRONTAL B04
ESC. 1/20

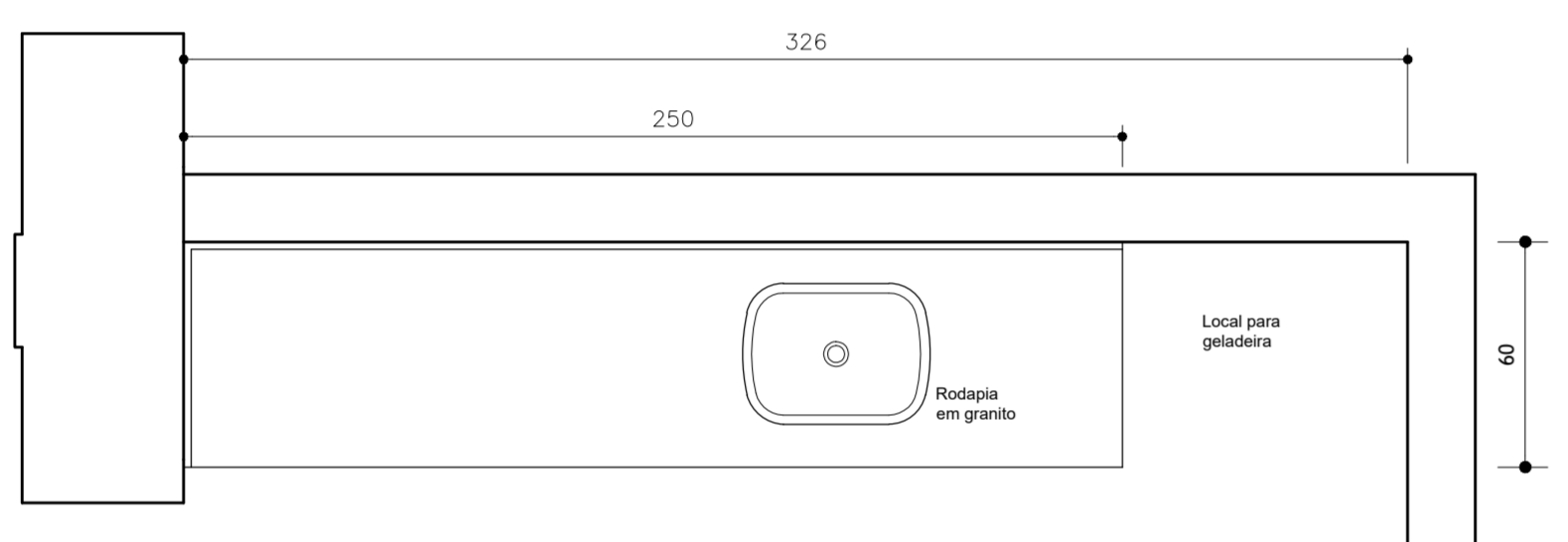

PLANTA BAIXA B05
ESC. 1/20

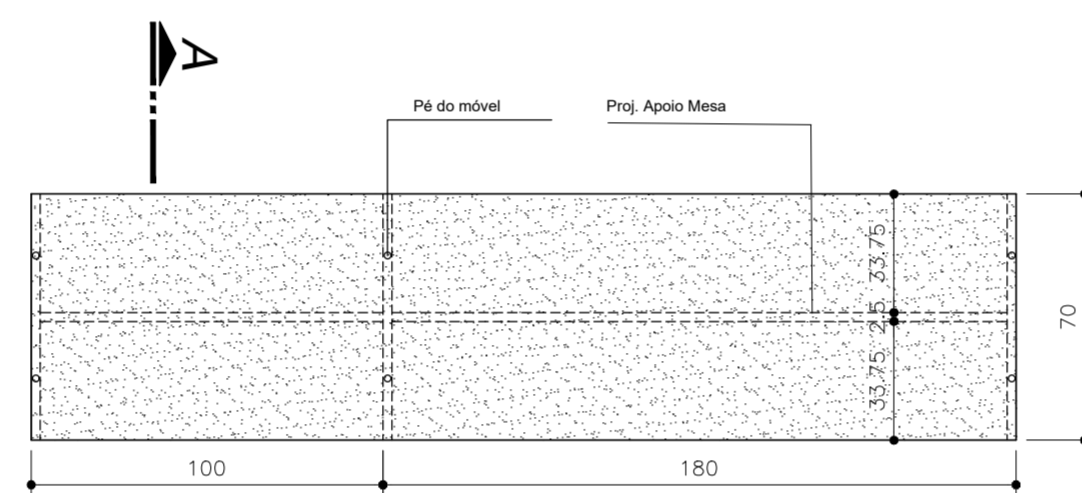

PLANTA BAIXA BA01
ESC. 1/20

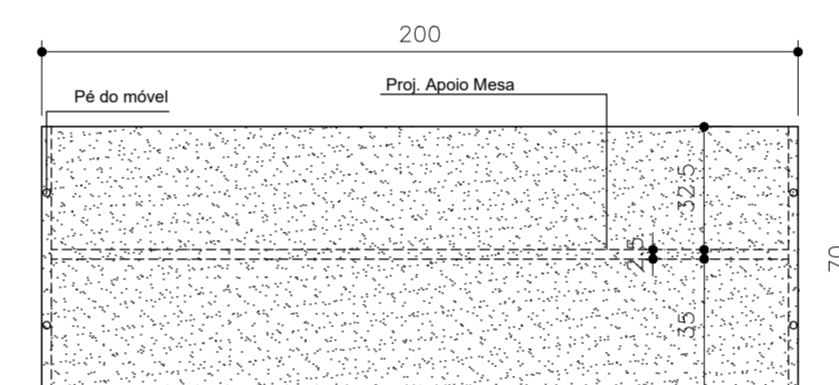

PLANTA BAIXA TAMPO BA02
ESC. 1/20

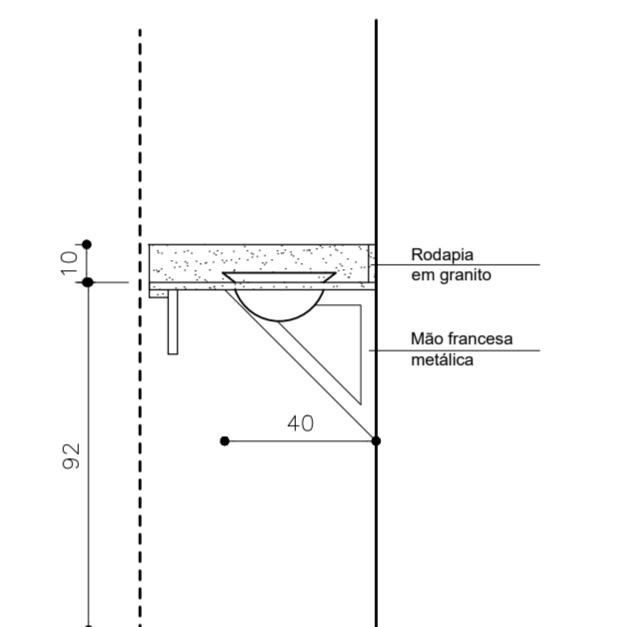

CORTE AA B03
ESC. 1/20

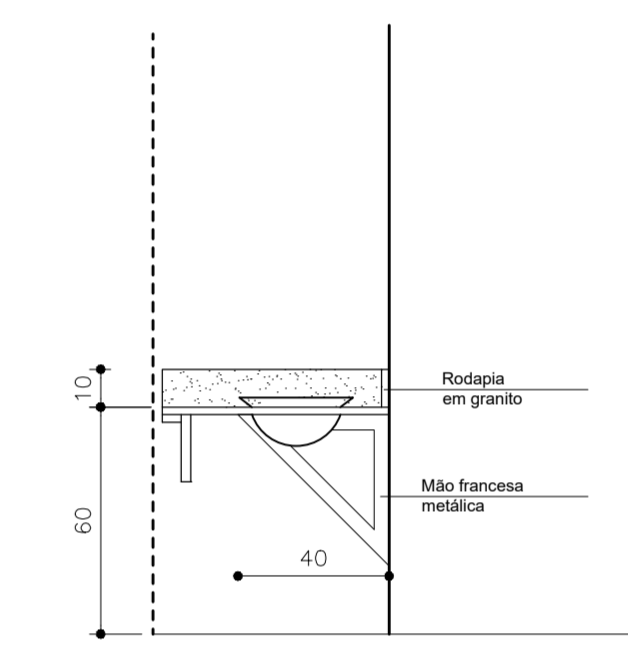

CORTE A B04
ESC. 1/20

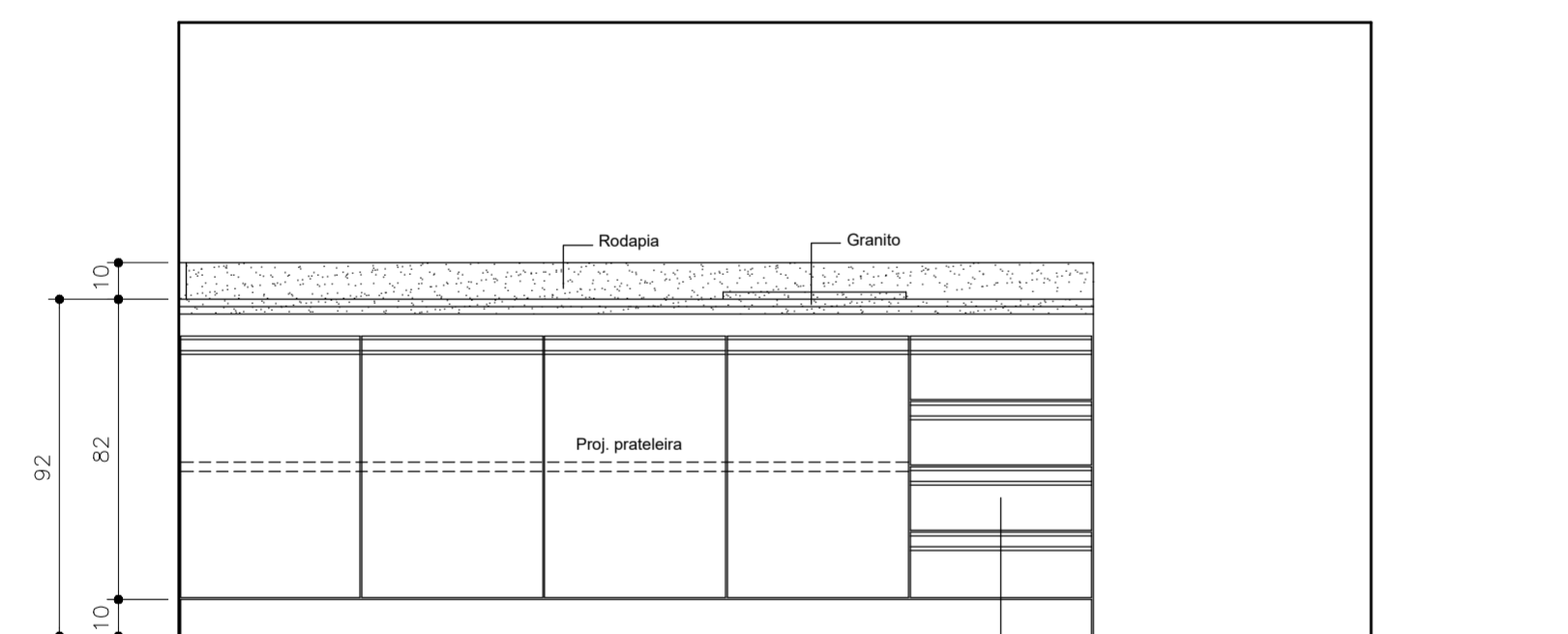

VISTA FRONTAL B05
ESC. 1/20

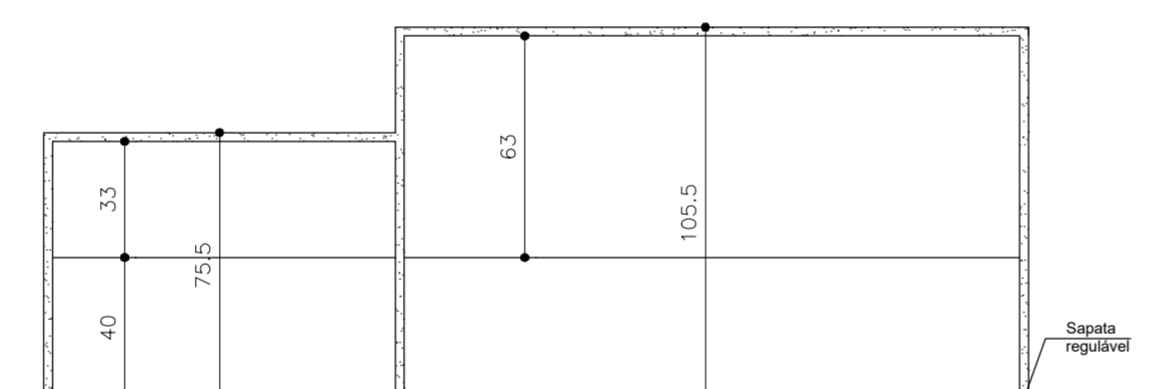

VISTA FRONTAL BA01
ESC. 1/20

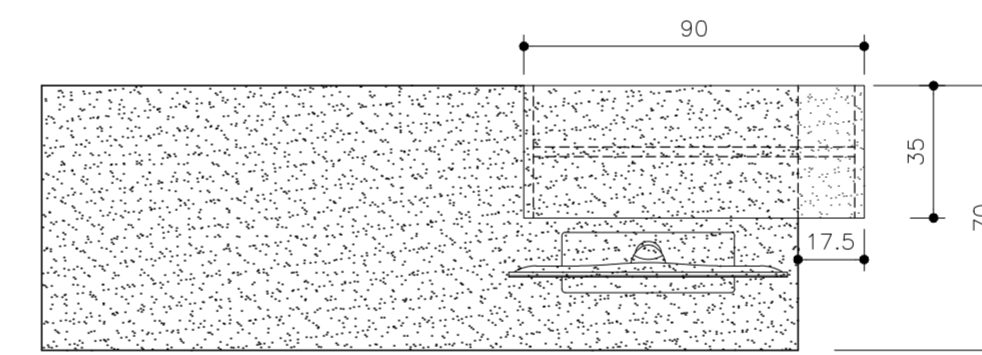

PLANTA BAIXA BANCADA SUP. BA02
ESC. 1/20

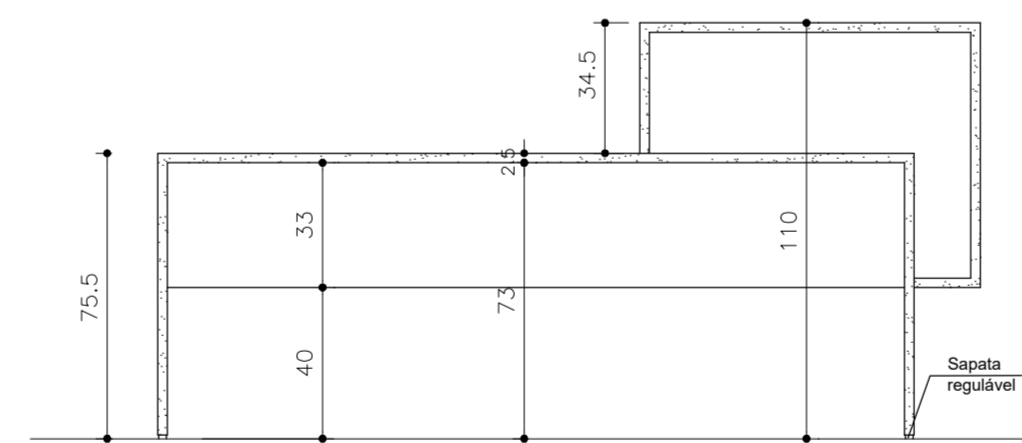

VISTA FRONTAL BA02
ESC. 1/20

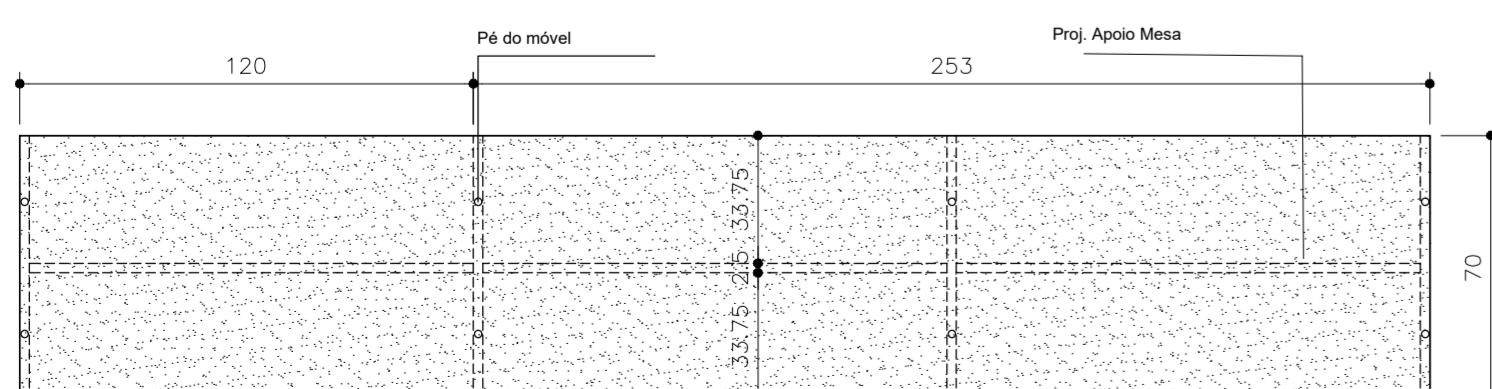

PLANTA BAIXA BA03
ESC. 1/20

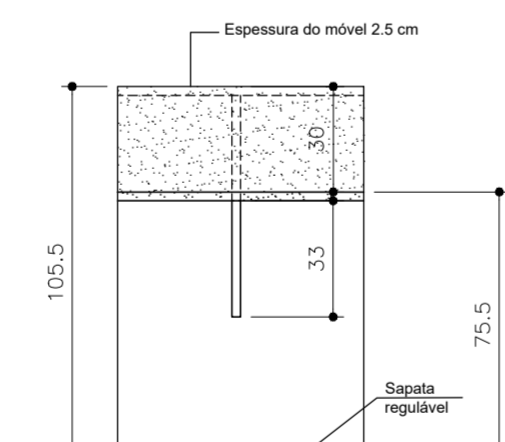

CORTE A BA01
ESC. 1/20

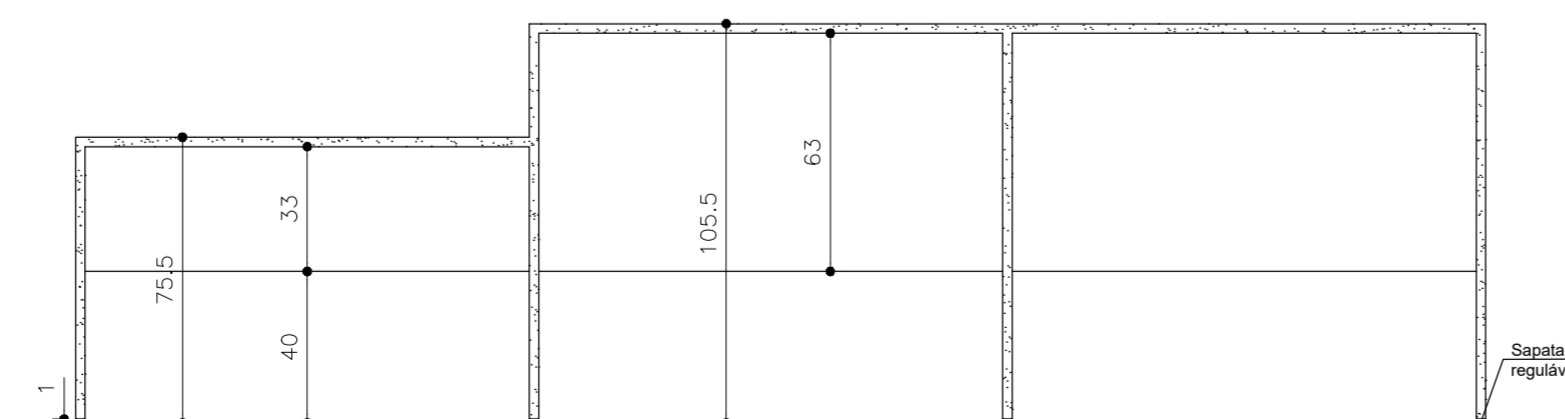

VISTA FRONTAL BA03
ESC. 1/20

MODALTEC ENGENHARIA LTDA - ME

Crea-SC Nº 127.959-0

Rua Leoberto Leal Nº 150 - Bairro São Vicente - Favela d Oeste - SC
 Fone: (49) 3522 6663 (Fixo)

Observações:
 Qualquer alteração deverá ser autorizada pelo responsável técnico do projeto
 Dimensões em centímetros (cm), diferenças entre as cotas e medidas, prevalecem as cotas
 É indispensável consultar os projetos complementares
 Direitos autorais reservados, conforme Lei Federal 9.610/98, ART 70º, itens X e XI ART 1º

Obra: **REFORMA E ADEQUAÇÃO DA SEDE DA PREFEITURA MUNICIPAL DE IOMERÉ/SC**
 R. João Rech, Iomeré - SC

Autor do projeto:	Conteúdo: Plantas Baixas e Vistas - Móveis	Referência: Projeto Executivo - Móveis
Arq. Marco Aurélio Bissani CAU/SC nº A 23186-0	Área total: 2.419,01 m²	Escalas: Indicadas
Proprietário: MUNICÍPIO DE IOMERÉ	Data: 08/2019	Desenho: Regina Franck e Daniel Deitos